

JR AUTOMATION™

A Hitachi Group Company

Think. Solve. Create.

FAST FACTS

Industry

Aerospace

Cycle Time

High

Numerous robotic material handlers

Numerous component processes

Integration between MES and ERP

Fusion of Robotic SI and Digital Technologies

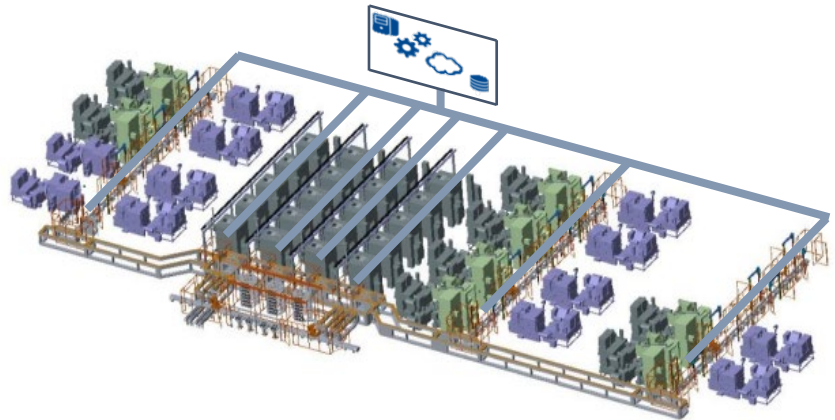

CHALLENGE

An aerospace customer needed automation of large-scale robotics, component processing, and conveyors while integrating an MES system with their ERP system. Their complex array of CNCs, CMMs, OMMs and custom cells all made unique parts – in quantities of one. Additionally, different parts required different machine setups and configurations.

OUTCOMES AND BENEFITS

Improved cycle time, work flow and line balancing. We were able to coordinate with the customer's existing ERP system, allowing for consistent and familiar output for the management team.

SOLUTION

The team at JR Automation architected and implemented a cell controller which would schedule and route parts through the cell. The cell controller was able to complete part scheduling, line balancing, tool life monitoring, and work instructions. This system was developed using industry standard MES systems along with JR SCADA systems.